

RESTORATION OF TEMPORARY BRIDGE CROSSING SITE

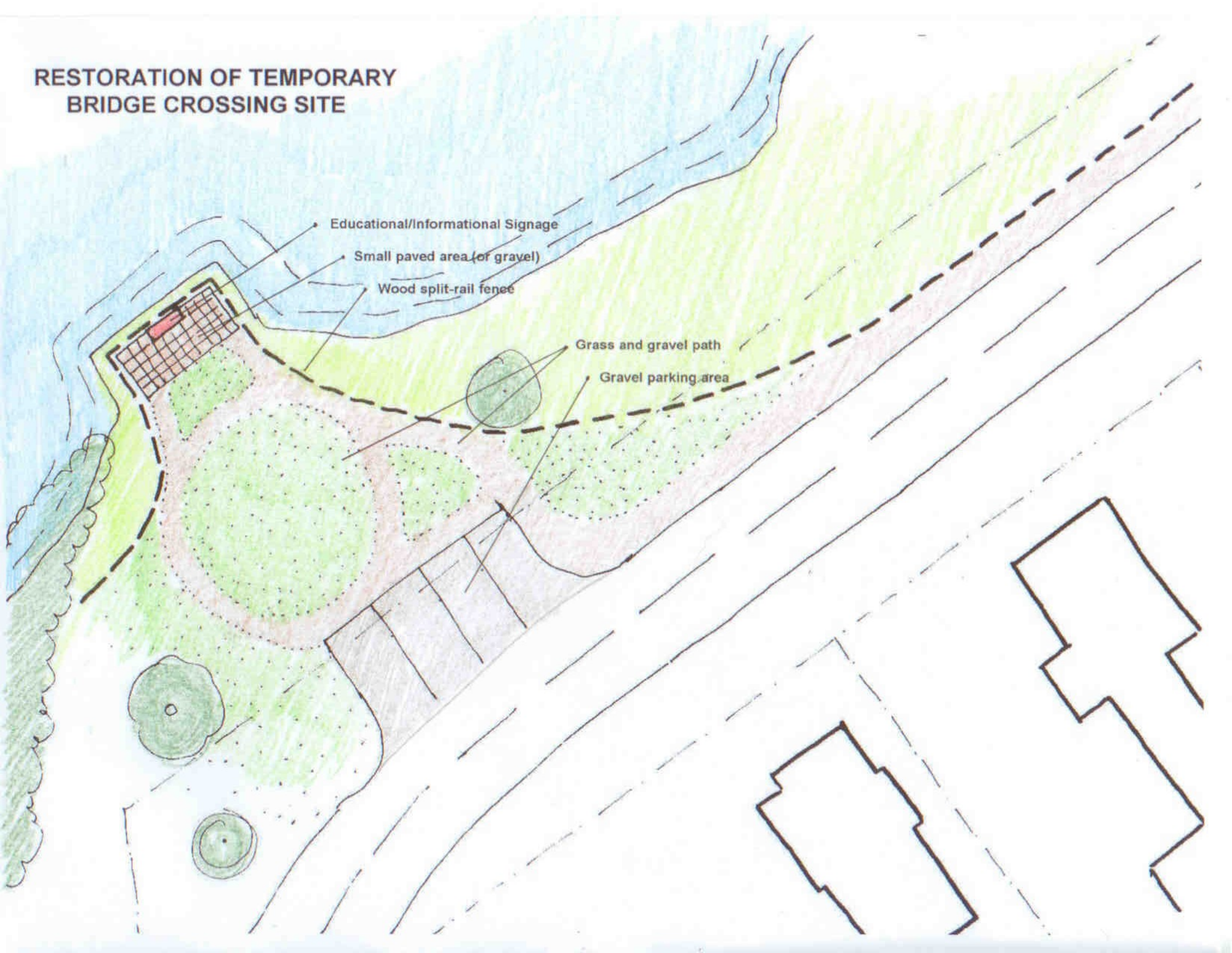

GARDINER WATER DISTRICT AND WEST STREET INTERSECTION IMPROVEMENTS

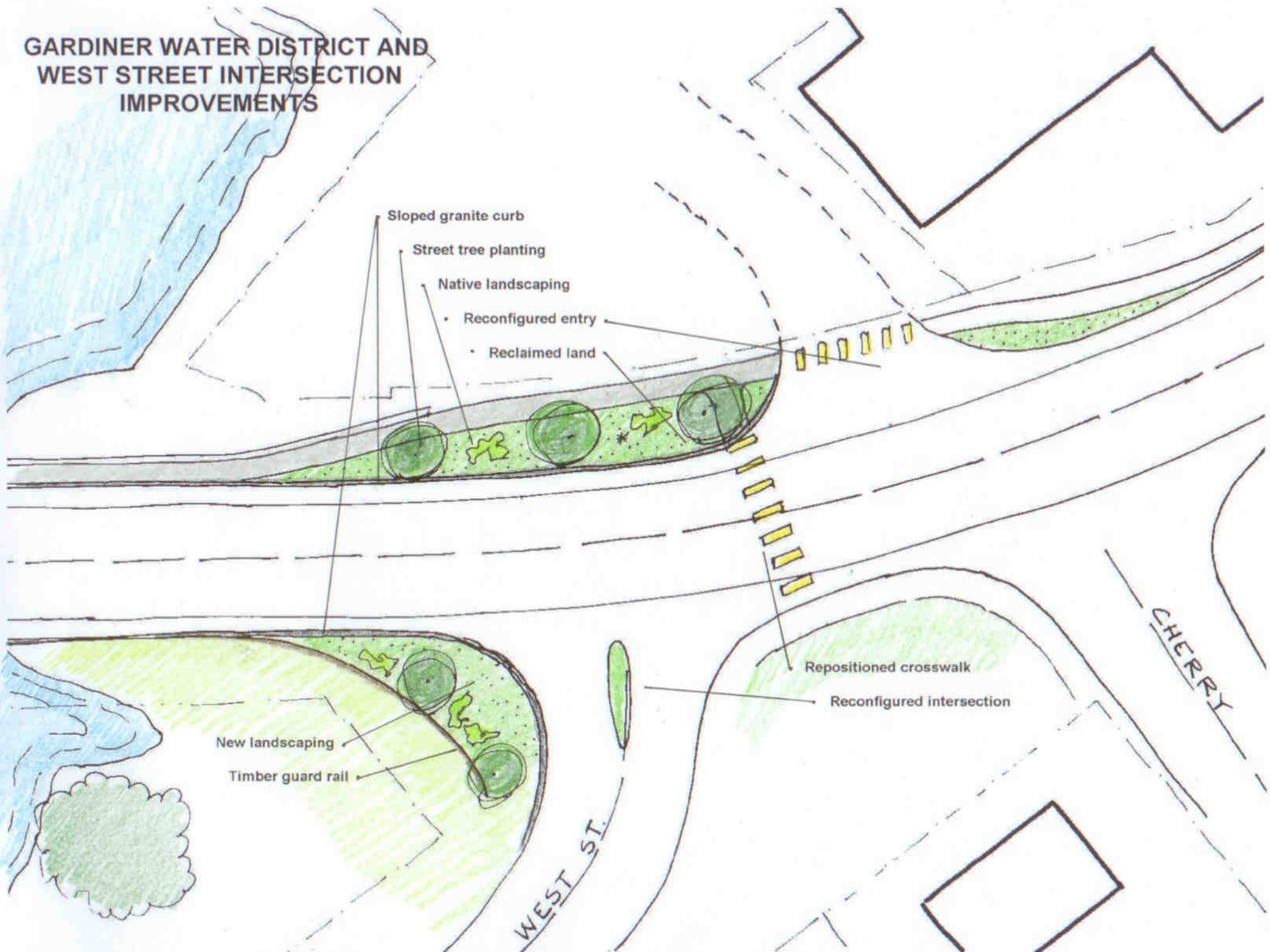

Sloped granite curb

Street tree planting

Native landscaping

• Reconfigured entry

• Reclaimed land

New landscaping

Timber guard rail

Repositioned crosswalk

Reconfigured intersection

WEST ST.

CHERRY

HARRISON/ANDREWS AREA IMPROVEMENTS

